



AireGard.

Hand Dryer

X1 SERIES USER MANUAL



PREFACE

This user manual contains a comprehensive installation guide and detailed information on the correct installation of the unit, which must be adhered to completely, including routing of electrical cables. Damage caused by incorrect installation is not covered by your warranty. Installation must be done by a qualified electrician.

AireGard will not be held liable for any damage to property or personal injury, or any loss of business or revenue, if you, your staff, your installer or service engineers have not followed the instructions given in this manual and the installation guide.

IMPORTANT SAFETY INSTRUCTIONS

BEFORE INSTALLING OR USING THIS UNIT, READ ALL INSTRUCTIONS AND CAUTIONARY MARKINGS IN THIS MANUAL AND THE INSTALLATION GUIDE.

WARNING!
TO REDUCE THE RISK OF FIRE, ELECTRIC SHOCK,
OR INJURY TO PERSONS, OBSERVE THE FOLLOWING:

Installation of the main unit

1. This unit is not intended for use by persons (including children) with reduced physical, sensory or reasoning capabilities, or lack of experience and knowledge, unless they have been given supervision or instruction concerning use of the unit by a person responsible for their safety.
2. Do not allow the hand dryer to be used for any purpose other than drying hands. Use this unit only in the manner intended by the manufacturer. If you have questions, contact the manufacturer.
3. Before servicing, switch the power off at the service panel. Ensure the switch is locked to prevent the power from being switched on accidentally. If the means of switching off the power cannot be locked, securely fasten a prominent warning device, such as a tag, to the service panel.
4. Children should be supervised to ensure that they do not play with this unit.
5. Do not use any jetwash equipment for cleaning on or near this unit.

CAUTION

Your hand dryer should be located indoors. Operating temperature range 0°C (32°F) to 40°C (104°F). To reduce the risk of fire or electric shock, do not expose the internal mechanisms/-components of this unit to moisture.

Parts description

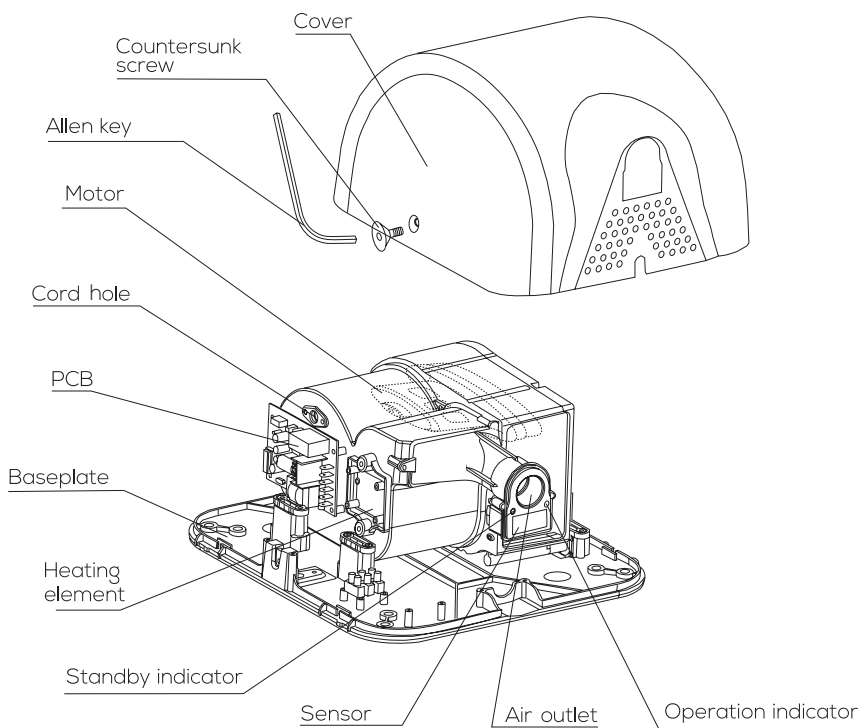

PRECAUTION FOR THE INSTALLATION LOCATION

Avoid installing in the following areas

- Temperature below 10°C or above 40°C.
- Exposed to direct contact with water.
- Exposed to direct sunlight.
- Exposed to corrosive and hazardous gas.

Installation location

- The following diagram shows the recommended location for installation.
- The unit must be installed on a flat wall
- Ensure the installation location does not interrupt the walkway.

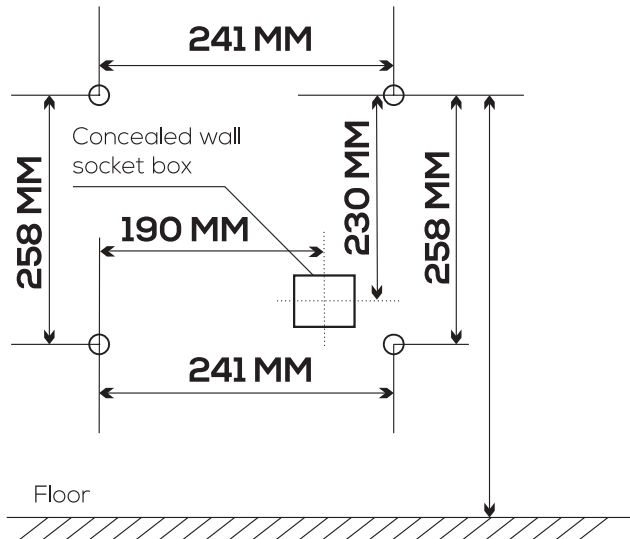

- Power cord should be 1.0 mm² - 1.5 mm²

INSTALLATION METHOD

Connecting the power supply cable

1. For installation without a junction box, ensure the power supply cable output is aligned with the thread hole, at the bottom right of the unit (fig.4). The power supply cable must be at least 300mm in length. (fig. 1)

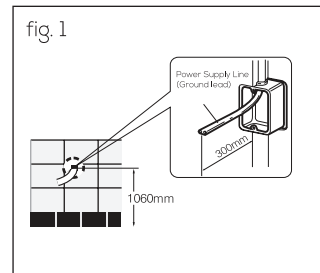

Removing the cover

1. Use the Allen key provided to remove the two countersunk bolts located at both sides of the unit. (fig. 2)
2. Once the countersunk screws are removed, gently lift the cover.
3. Handle the cover with care to prevent scratches or damages.
4. To reinstall back the cover, gently place the cover on the unit and use the given Allen key to securely fasten the two screws. (fig. 3)

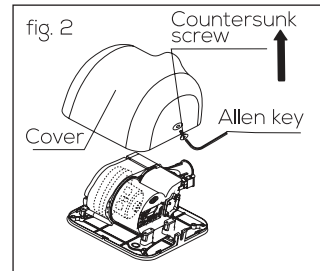

Installation of the main unit

1. Ensure the power cable is threaded through the thread hole at the bottom right of the unit.
2. Once the power cable is threaded through, securely mount the unit on the wall using the wall plugs and screws included.

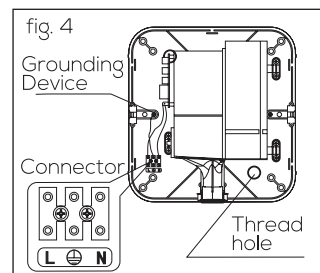
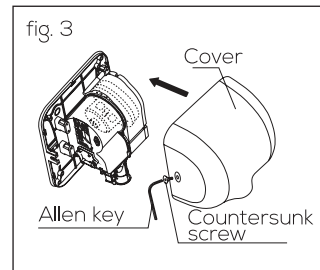

Attention! Always ensure that the main power is switched off during installation to avoid risk of electrocution.

Operating instructions

- 1. Place your hands beneath the hand dryer and it will start automatically, creating sheets of air to scrape water from your hands.
- 2. Move your hands back and forth slowly through the air, turning them over so both back and front are exposed to the airflow.

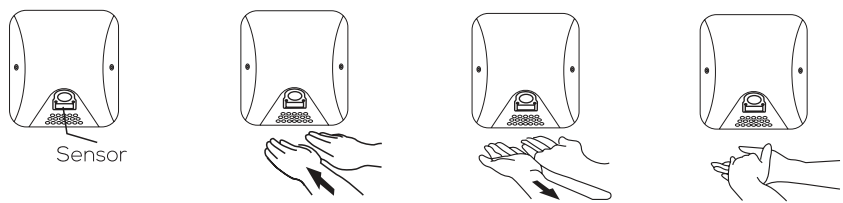

Maintenance

- 1. The hand dryer should be cleaned daily.
- 2. Wipe all surfaces with a soft cloth and non-abrasive cleaner from top to bottom. Avoid wiping in circular motion.
- 3. Do not use chemical cleaning agents.
- 4. Clean the floor, wall beneath and around the unit.

PACKING LIST

- Main unit – 1 pc
- Allen key – 1 pc
- User manual – 1 pc
- 5 x 25mm self-tapping screws – 4 pcs
- Wall plugs – 4 pcs

Specification

Voltage	AC 220-240W	Motor	Brush motor
Phase	Single-Phase	Sensing Distance	15-20cm
Input	1400-1650W	Protection Class	IPX1
Wind Speed	380kmh / 105ms	Appearance Size (WxBxH)	295x170x320mm
Heating Power	800-950W	Weight	4.4KG

Electrical diagram

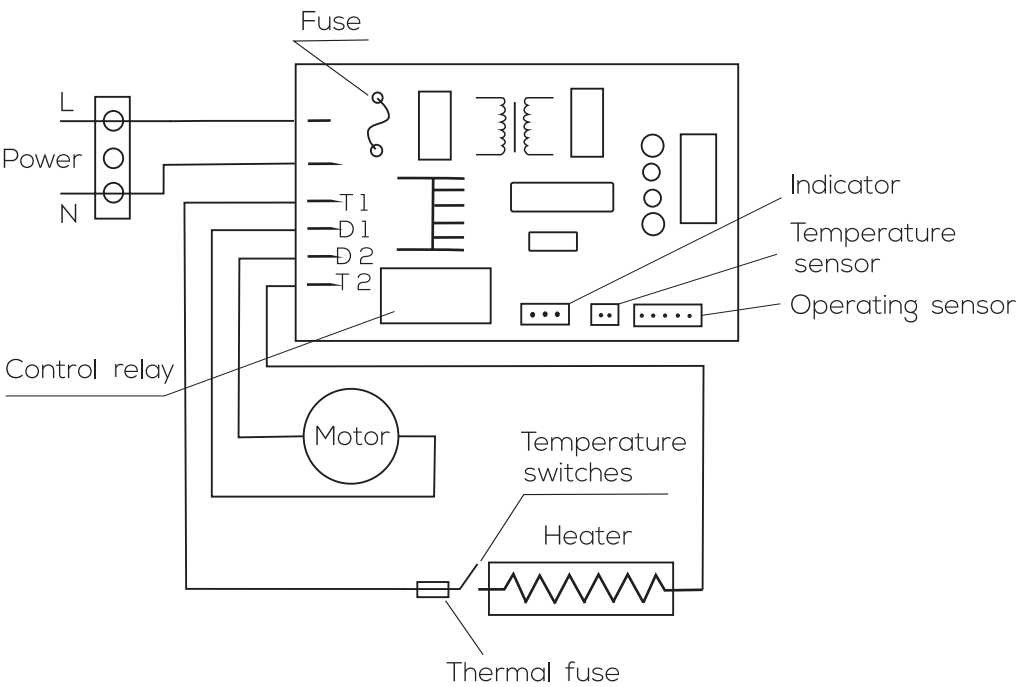

DISTRIBUTED BY:

Gard Inc. Sdn Bhd (833000-K)

No. 13, Jalan Budiman,
Budiman Business Park,
Bandar Sungai Long,
43000 Kajang, Selangor.

Toll-free: **1300-88-4273**

www.HandDryer.asia